

Practical Guide

How to Choose the Gripper Fingers of the Fastening Clamps

Standard Gripper Fingers for Fastening Clamps

Fastening Clamps have been designed to immobilize the workpiece in a tool while some action is being made on it: welding, assembly, verification, etc. For this purpose, **gripper fingers suited to the geometry of the workpiece** are required.

Our Fastening Clamps have a complete range of **interchangeable and standard** gripper fingers consisting of:

- Screws: jaw blocks, screws –ball-ended or not– with the end in different materials.
- Specific holders (couplings and lower brackets) are used to fix the screws to the clamping arm and body of the clamp.

There are many **advantages** of using standard gripper fingers: they are easy to assemble, to adjust and to maintain; it is not necessary to manufacture any special parts; they are very economical; and spare parts are always in stock.

But when should each element be used? How could they be combined with each other?

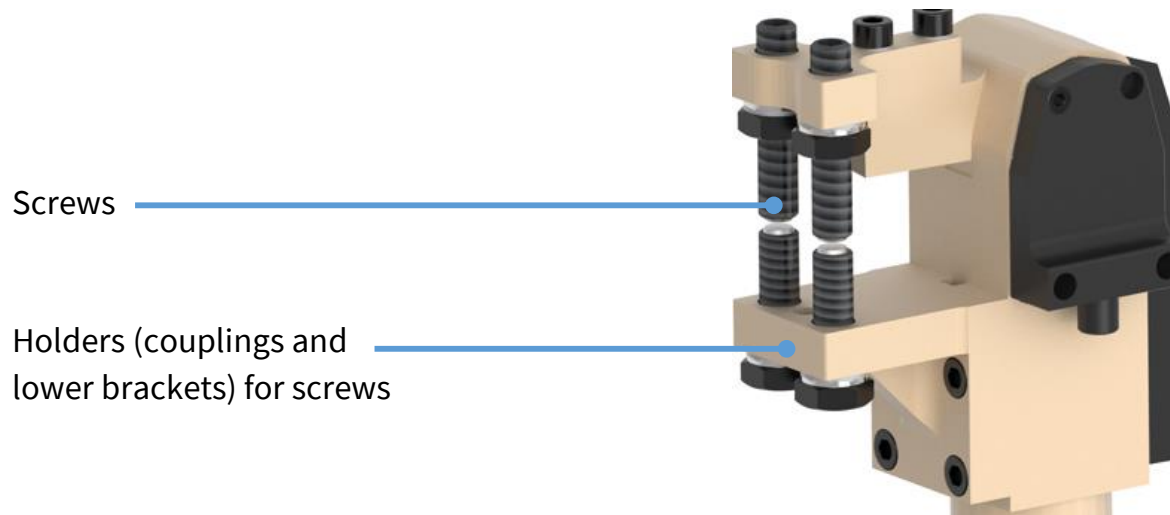

1. Range of Screws and Jaw Blocks

Misati's range of standard screws and jaw blocks consists of:



ref. RG-... / RGI-...
Ribbed ball-ended
screws



ref. RP-...
Flat ball-ended screw
with steel surface



ref. RPP...
PEEK flat
ball-ended screw



ref. RBP...
Ball-Ended Screw with a
Thermoplastic Contact Surface

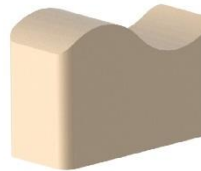

ref. SCN-A...
Jaw blocks

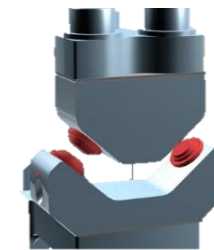

ref. SCN-A-... + ref. RGI...
Jaw blocks +
inserted ribbed ball-ended screws

2. Which is the most Appropriate Gripper Finger to Fasten my Workpiece?

→ The shape, thickness and material of the workpiece to be fastened with the clamp determines the type of gripper finger to use.

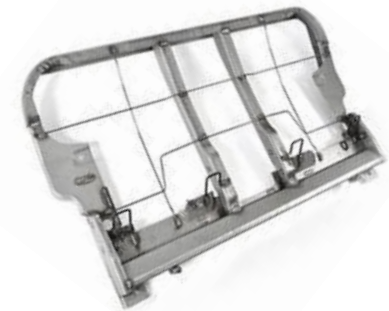
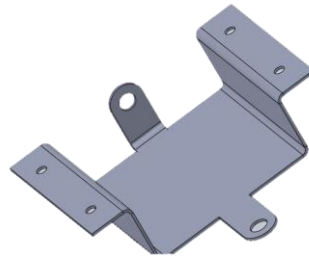
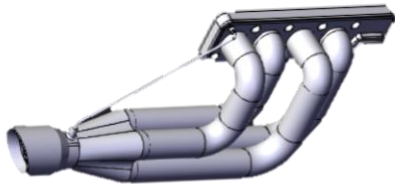

3. Standard and Interchangeable Holders

Once it has been determined which are the best screws or jaw blocks for our workpiece, how should we attach them to the clamping arm? By means of some **standard and interchangeable holders**. Thanks to these **holders**, the **mechanical circuit is closed on the clamp itself** and no stresses are transmitted to the tool.

Holders for the clamping arm

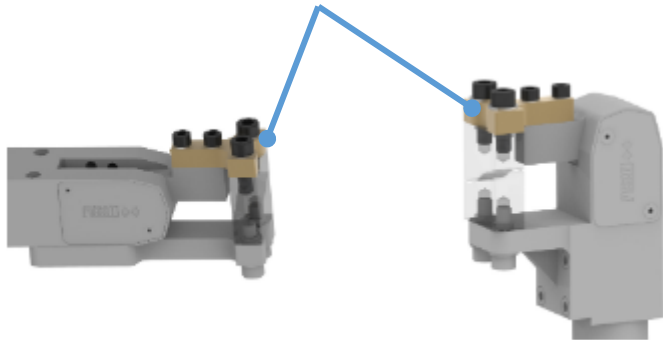





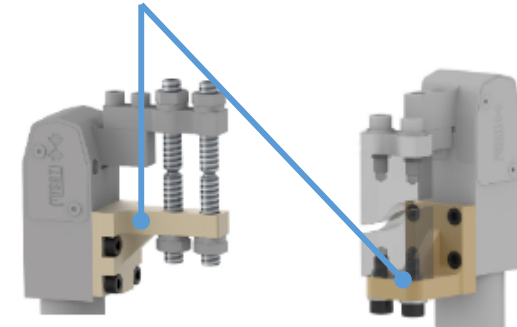







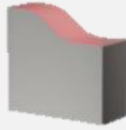



Holders for the clamping arm are screwed to the clamping arm and house the screws or jaw blocks.

Reaction holders

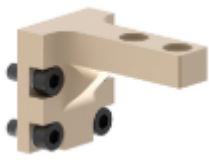

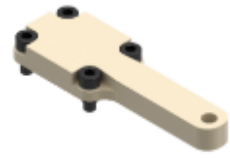
Reaction holders or brackets are screwed to the body of the clamp and house the reaction gripper fingers.

4. Guide to Choose the Holders

Type of screw or jaw block	1 screw 	2 screws  <i>transverse</i> <i>longitudinal</i>		Jaw blocks  <i>transverse</i> <i>longitudinal</i>	
 Holders for the clamping arm <i>BLN-..., BIN-... and BCN... clamps</i>	AN-RG1-... 	AN-RG-... 	AN-RGL-... 	AN-SC-... 	A-SCL-... 
 Reaction holders <i>BLN-... clamps</i>	FLN-RG1-... 	FLN-RG-... 	FLN-RGL-... 	FLN-SC-... 	FLN-SCL-... 
<i>BIN-... clamps</i>	FIN-RG1-... 	FIN-RG-... 	FIN-RGL-... 	FIN-SC-... 	FIN-SCL-... 

Thank you for your attention.

For more information, please visit our website
www.misati.com

